

TPV Automotive – Plant Šentlenart



TPV AUTOMOTIVE



Lay-out

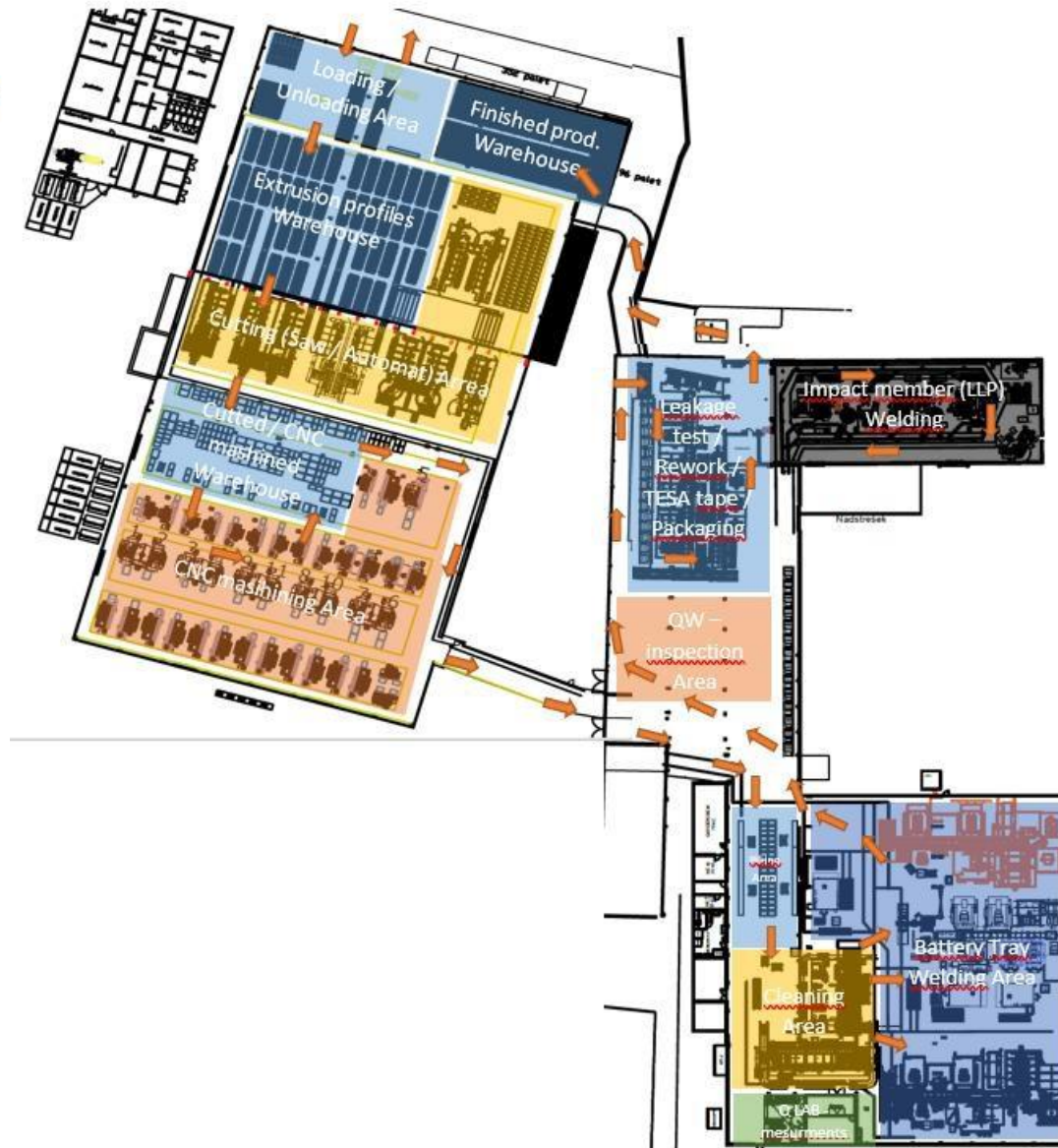

Process:

Entrance: 6m Al profiles, screws, nuts, rivets

Automatic cutting line with robotization - 10 pcs

CNC machining centers with robotization - 40 pcs

Automatic washing line for degreasing and passivation Al - 2 pcs

High - tech FSW and MIG-MAG welding line, riveting, sealant application, geometry control - 3 pieces

Robotized control line of special technical requirements - 1 piece

Robotized line for tightness control, rework, installation of protection and packaging - 1 piece



Equipment: Automated SAWS

Faster and more accurate cutting method

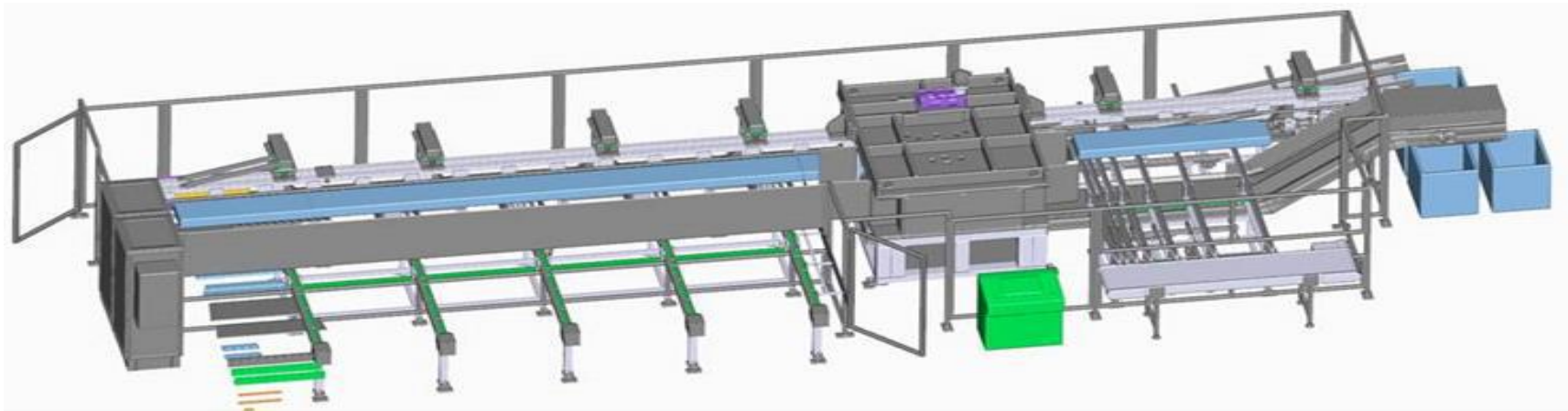
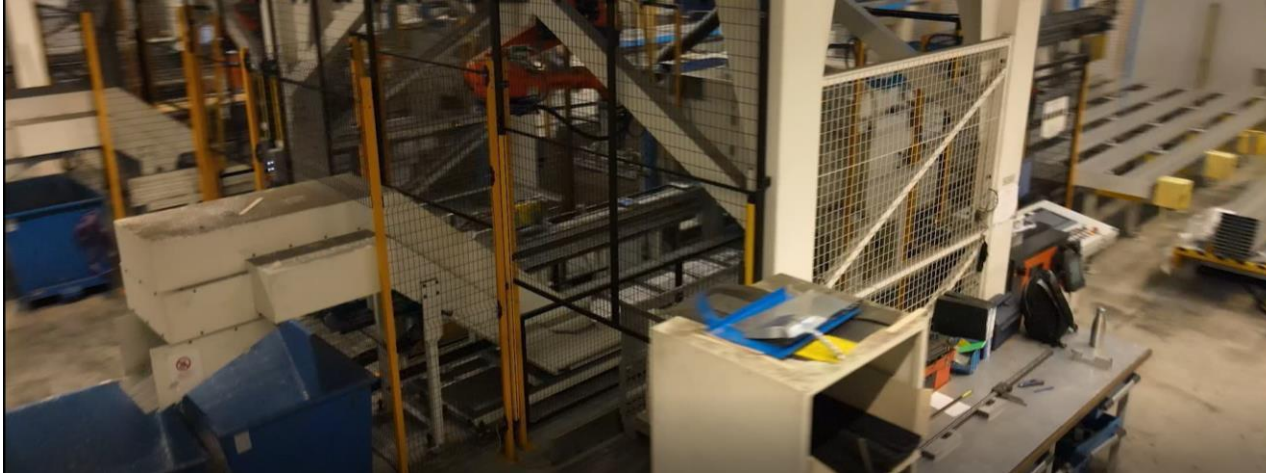

10x



CNC centers with a robotic server

The processing quality is stable with high precision and high repetition accuracy



Automatic washing line

The process removes various impurities, such as oils and dirt from aluminum surfaces.



BT 621B

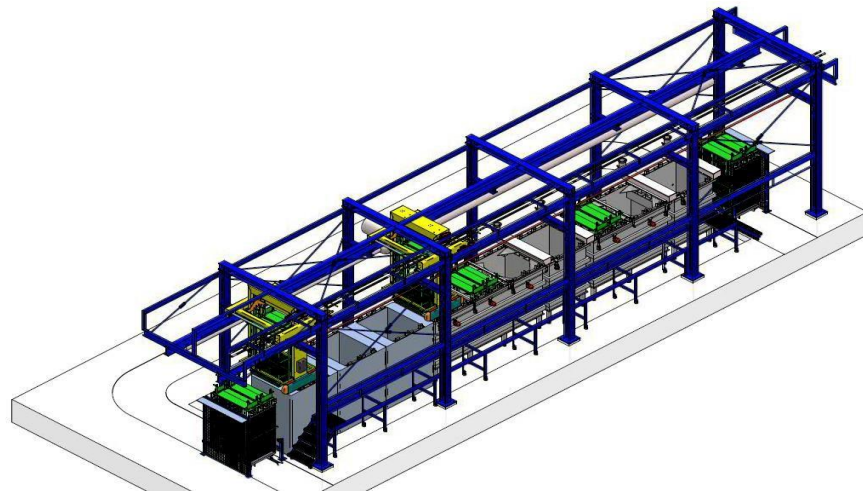

FSW, MIG welding and sealing line

Increase in productivity as a result of line production.

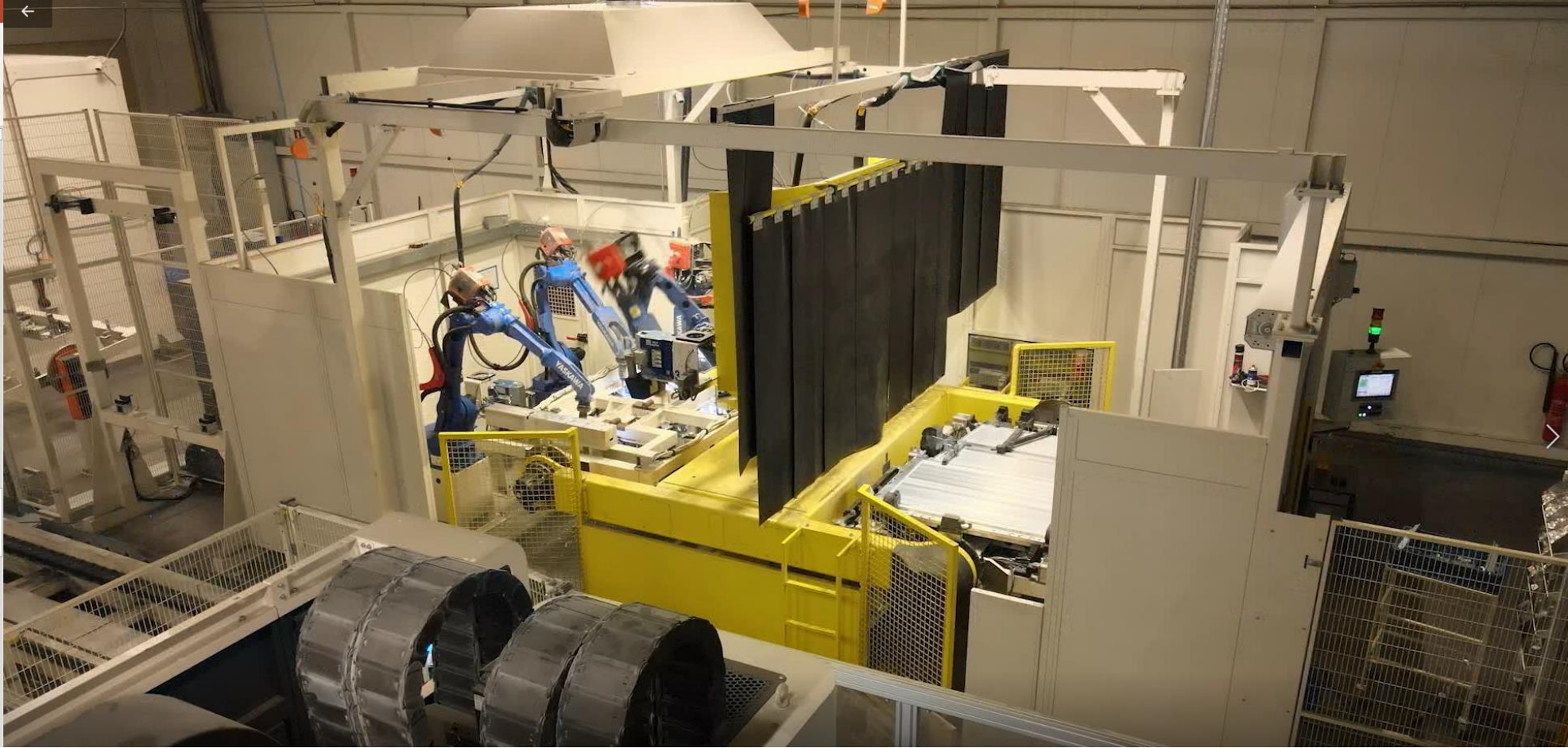

3x



TREG line - control according to the requirements of technical regulation

Implementation of special customer requirements.



BT 621B

1x



Leakage control and repairs, surface protection

Ensuring proper sealing of the battery carrier with increased productivity.



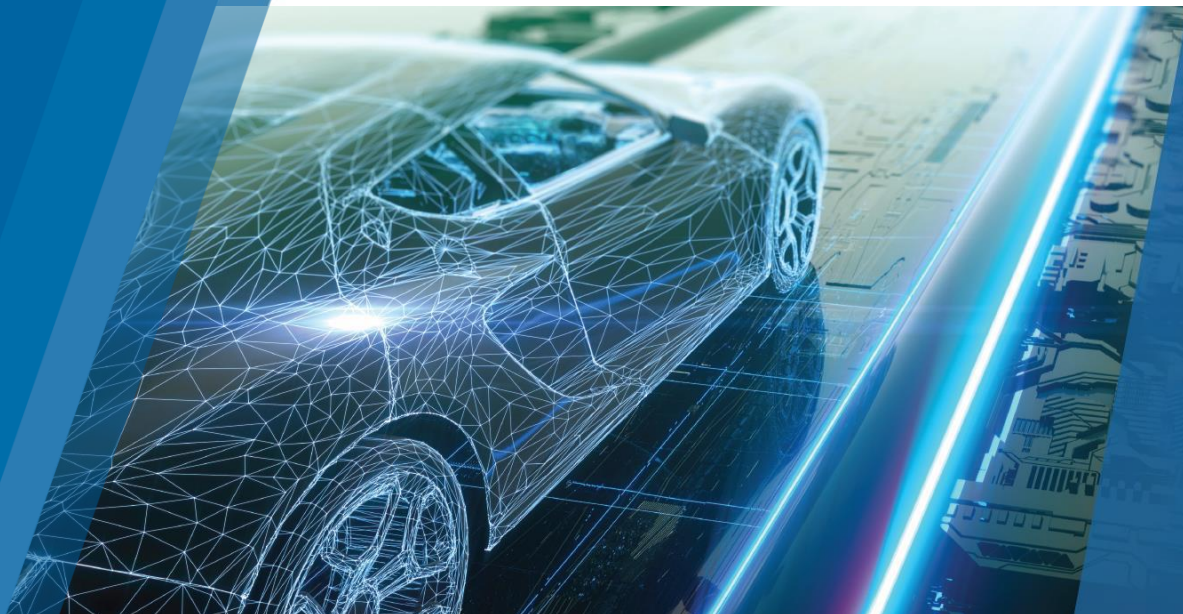

Ustvarjamo mobilnost prihodnosti

Creating mobility of the future